

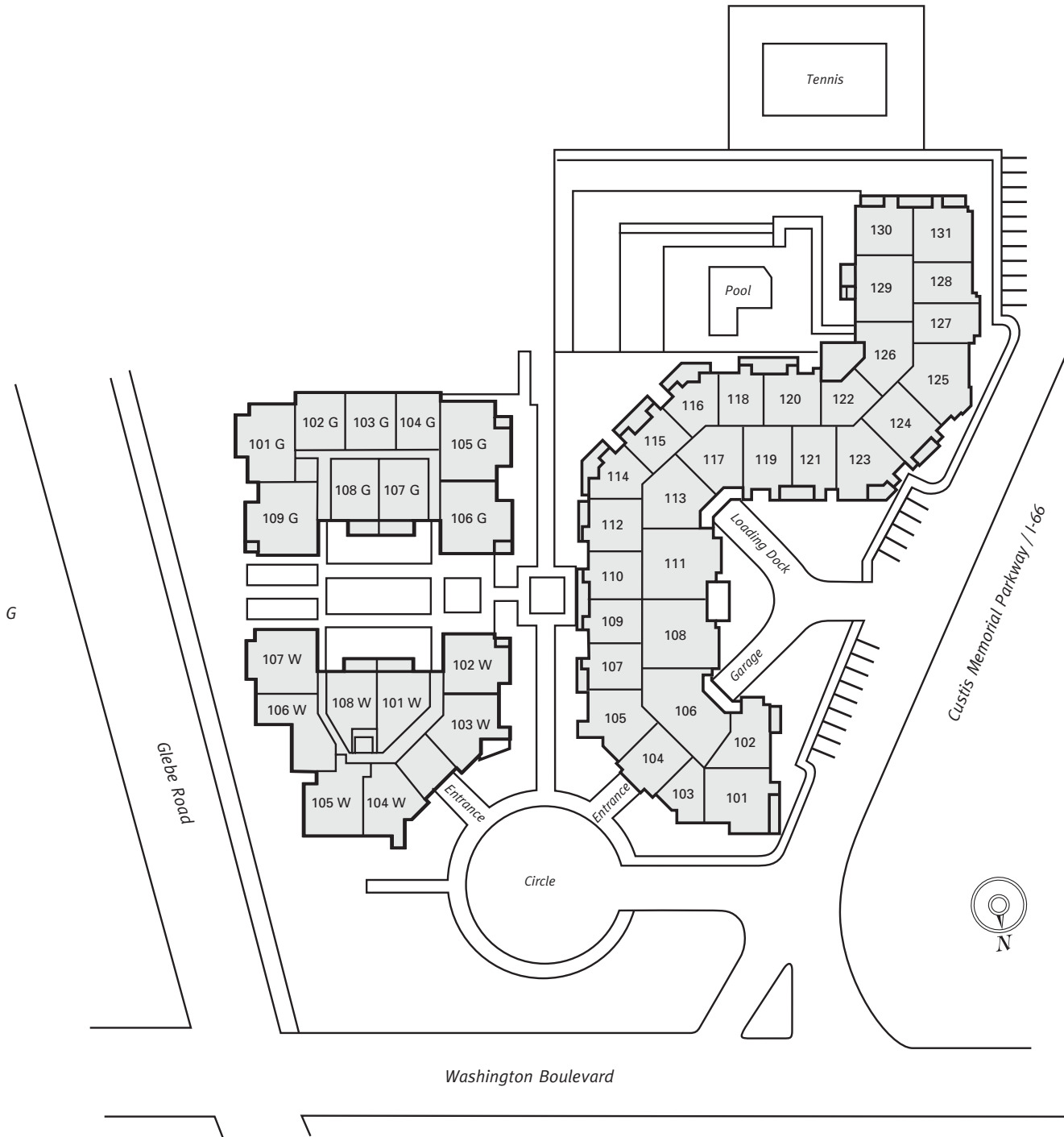

Avalon ^{at} Ballston
WASHINGTON TOWERS

- The Abingdon I* 103 W
- The Abingdon II* 104 W
- The Bedford* 107, 112, 118, 120
- The Bellingham* 129 Tier, ninth and tenth floors
- The Broyhill* 108 W
- The Calvert* 106
- The Devon* 104 W Tier, second and third floors
- The Easton* 105 W
- The Hampton* 102 W, 107 W, 101 G, 105 G, 106 G, 109 G
- The Hollinswood* 103 G, 107 G, 108 G
- The Kendall* 102
- The Kensington* 109, 110
- The Manchester* 105
- The Nottingham* 103
- The Oakland* 108, 111
- The Piedmont* 129
- The Potomac* 114, 116, 123, 125
- The Richmond* 106 W
- The Rockingham* 104, 115, 124
- The Stratford* 101, 130, 131
- The Stuart* 103 W Tier, second and third floors
- The Trenton* 119, 121
- The Wakefield* 127, 128
- The Warwick* 113, 117, 122, 126
- The Wesley* 102 G, 104 G
- The Woodmont* 101 W



4650 North Washington Boulevard • Arlington, VA 22201 • (703) 527-4409

This plan is meant for illustrative purposes only. Parking lot lines denote parking areas; actual number of spaces may vary from plan.

