



AVALON

POTOMAC YARD
FIRST FLOOR



We would like to take you on a standard tour route that may include a model apartment and many community amenities. If you wish to alter this route, see a specific apartment or see other community features, we can do so upon request.

This plan is intended for illustrative purposes only.

731 SEATON AVENUE • ALEXANDRIA, VA 22305 • 571-970-6208



AVALON

POTOMAC YARD
SECOND FLOOR



We would like to take you on a standard tour route that may include a model apartment and many community amenities. If you wish to alter this route, see a specific apartment or see other community features, we can do so upon request.

This plan is intended for illustrative purposes only.

731 SEATON AVENUE • ALEXANDRIA, VA 22305 • 571-970-6208



AVALON

POTOMAC YARD
THIRD & FOURTH FLOORS



We would like to take you on a standard tour route that may include a model apartment and many community amenities. If you wish to alter this route, see a specific apartment or see other community features, we can do so upon request.

This plan is intended for illustrative purposes only.

731 SEATON AVENUE • ALEXANDRIA, VA 22305 • 571-970-6208



AVALON

POTOMAC YARD
FIFTH FLOOR

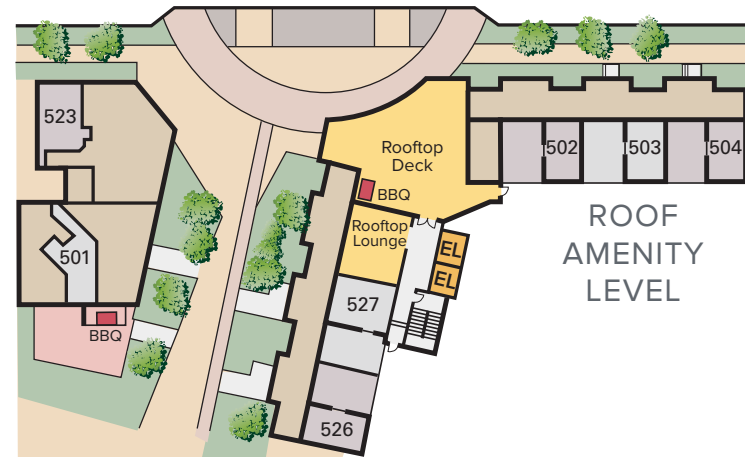

We would like to take you on a standard tour route that may include a model apartment and many community amenities. If you wish to alter this route, see a specific apartment or see other community features, we can do so upon request.

This plan is intended for illustrative purposes only.

731 SEATON AVENUE • ALEXANDRIA, VA 22305 • 571-970-6208



AVALON

POTOMAC YARD GARAGE 1



We would like to take you on a standard tour route that may include a model apartment and many community amenities.
If you wish to alter this route, see a specific apartment or see other community features, we can do so upon request.

This plan is intended for illustrative purposes only.

731 SEATON AVENUE • ALEXANDRIA, VA 22305 • 571-970-6208



AVALON

POTOMAC YARD GARAGE 2

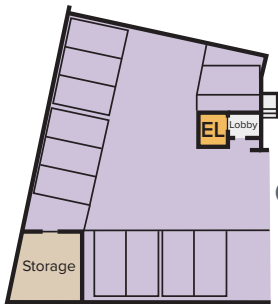

GARAGE 3

We would like to take you on a standard tour route that may include a model apartment and many community amenities. If you wish to alter this route, see a specific apartment or see other community features, we can do so upon request.

This plan is intended for illustrative purposes only.

731 SEATON AVENUE • ALEXANDRIA, VA 22305 • 571-970-6208

The floor plan illustrates the layout of the 10000 block of Maskell Street. It features two main building wings. The left wing contains units 113 through 122, with a lobby, resident lounge, and a loading area. The right wing contains units 103 through 114, including a leasing office, game room, pool, outdoor lounge, and fitness center. Common areas are marked with icons: mailboxes, a satellite dish, and a trash can. The plan also shows the location of the Main Line Boulevard and Potomac Avenue.

AVALON