



COMMUNITY PLAN

We would like to take you on a standard tour route that may include a model apartment and many community amenities.

If you wish to alter this route, see a specific apartment or see other community features, we can do so upon request.

This plan is intended for illustrative purposes only.

THE STATESMAN

2020 F STREET NW • WASHINGTON, D.C. 20006

PHONE: 202.331.8827

WELCOME TO THE STATESMAN

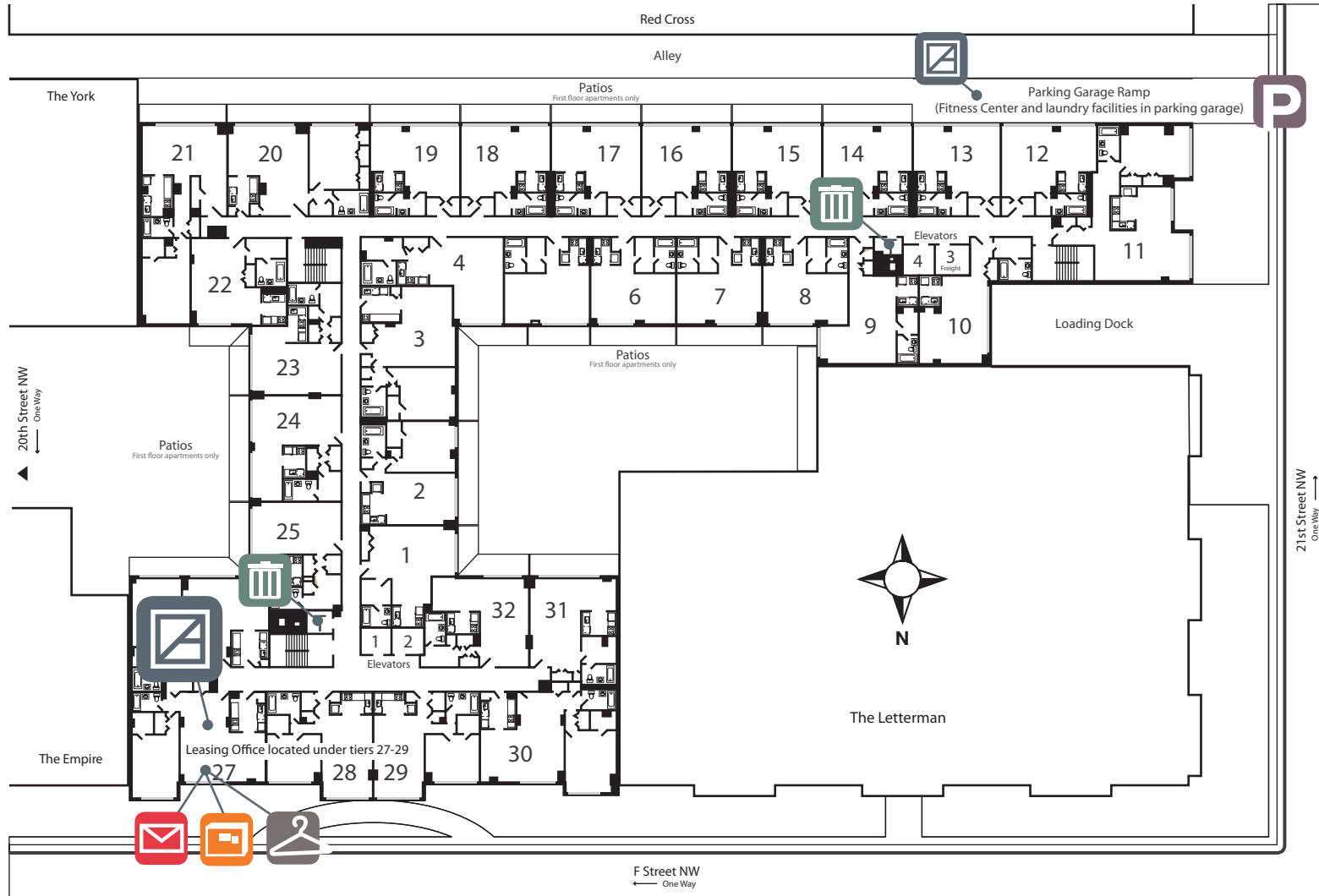

Parking Space # _____



LEASING OFFICE & AMENITY AREA



TRASH AND RECYCLING



PACKAGE PICK UP



DRY CLEANING DROP OFF



MAIL ROOM



PARKING ENTRY