

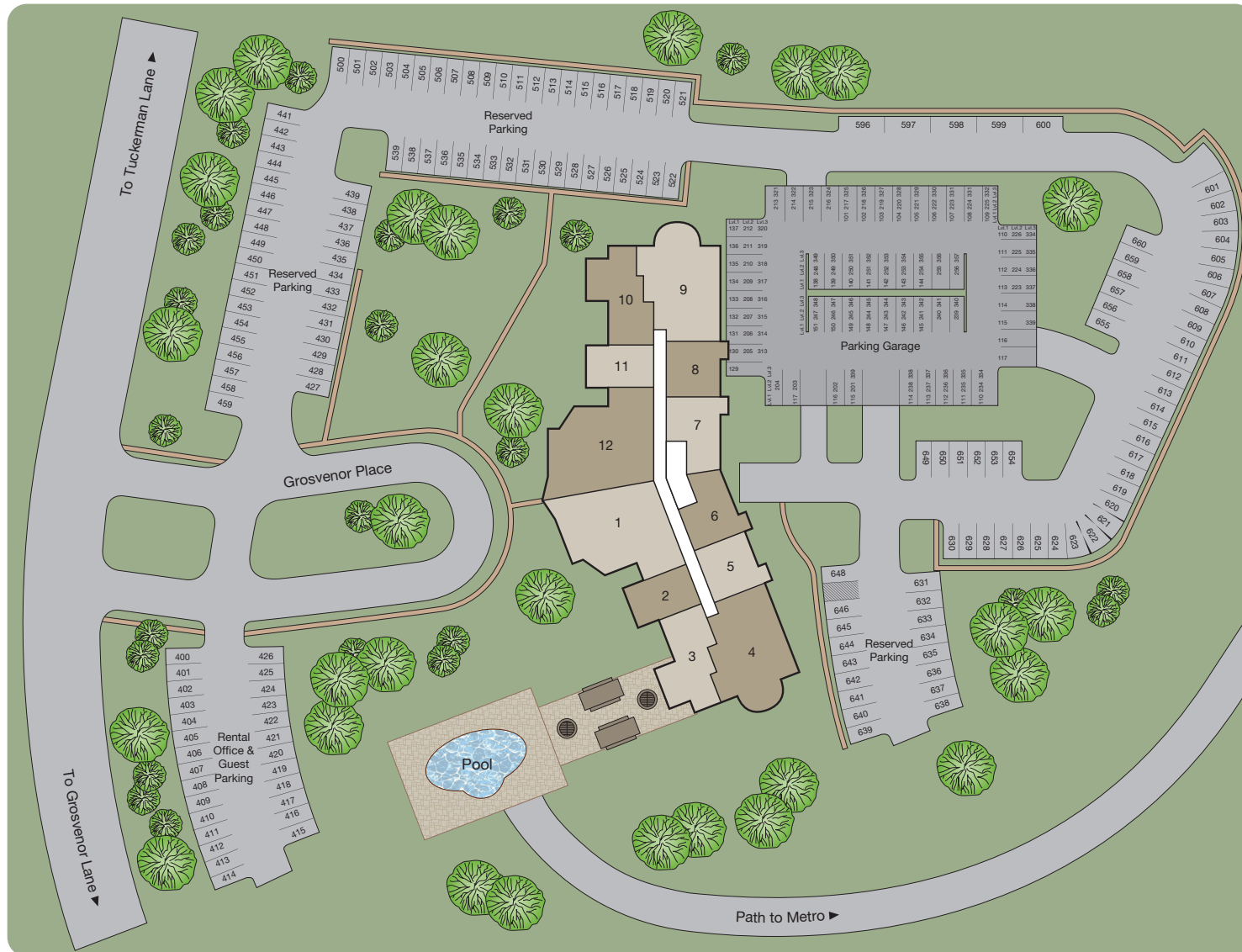

# AVALON

## GROSVENOR TOWER

### COMMUNITY PLAN



We would like to take you on a standard tour route that may include a model apartment and many community amenities. If you wish to alter this route, see a specific apartment or See other community features, we can do so upon request.

This plan is intended for illustrative purposes only.

10301 GROSVENOR PLACE • NORTH BETHESDA, MD 20852 • 301-530-5300

# WELCOME TO AVALON GROSVENOR TOWER

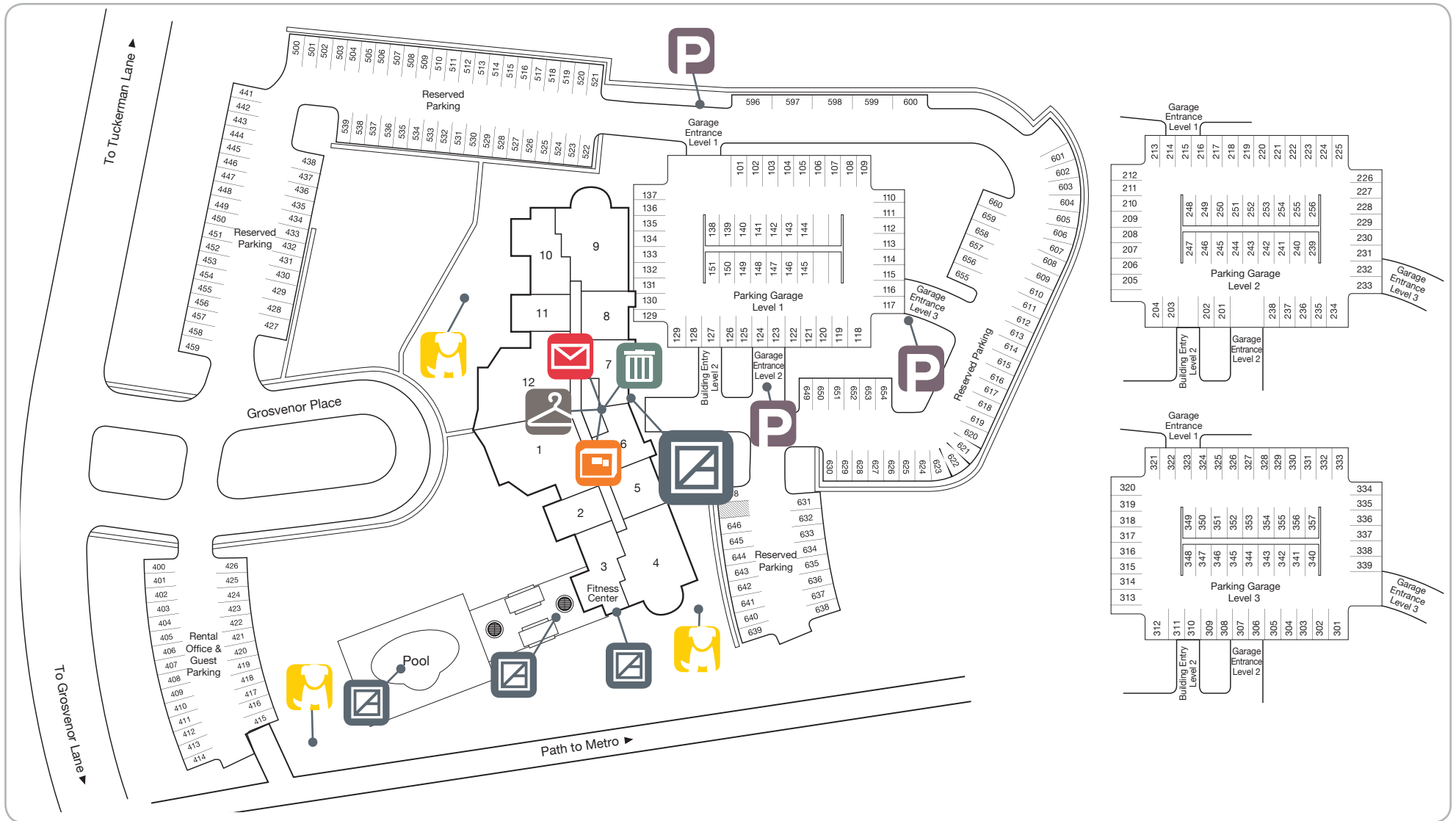

Parking Space # _____	 LEASING OFFICE & AMENITY AREA	 TRASH AND RECYCLING	 PACKAGE PICK UP	 MAIL ROOM	 <b>AVALON</b>
Mailbox # _____	 DRY CLEANING DROP OFF	 PET AREA	 GARAGE PARKING		
Storage # _____					